



Finished White POLYISO



Finished White Surface Polyiso for Concrete, Masonry, & Other Interiors

OX – Strong on Energy, Strong on Aesthetics:

Building scientists agree that one of the best ways to insulate concrete and masonry walls is on the inside with rigid polyiso insulation. A continuous thermal and vapor barrier that enables broad flexibility of exterior wall design. Then add OX's aesthetically pleasing, light-reflecting, durable finished white ISO RED MAX grades and your insulation doubles as a finished surface that is extremely cost effective to install and maintain.

Effective because OX ISO RED MAX finished white surface grades do not need to be covered with gypsum wall board (thermal barrier) to meet code. Install it directly to the interior of a concrete or masonry surface, finish the seams, and walk away with one of the smartest ways to finish commercial buildings and even residential spaces including basements & garages.



OX ISO RED MAX WF, LD, HD features:

- High R-values, as much as R-6.5 per inch. Thicknesses up to 4 inches, and lengths to 30' (dependent on thickness)
- Vapor barrier performance with closed cell foam structure to stop vapor drive for any climate
- Fiberglass reinforced foam core for durability on the jobsite and beyond.
- Embossed WHITE thermoset finished aluminum front facer for light reflectance, aesthetics, and durability.

Finish joints and edges with matching plastic extrusion moldings or white aluminum tape and you have a system that is a fraction of the cost of insulated metal panels or other options that would be needed to meet the architectural and code requirements of your facility.

So whether your building is cast-in-place, tilt-up, pre-cast, masonry block, or other applications where light-weight, rigid white faced panels are needed, specifying white finished ISO RED MAX is:

- Multi-functional
Thermal & Architectural
- One-step finished wall or ceilings
Light-weight & simple to install
- Easy to maintain
Cleanable with a cloth or light power-wash



OX ISO RED MAX Specifications

BUILD STRONG

Thermal R-Values "R" means resistance to heat flow. The higher the R-value, the greater the insulating value.									
Thickness	0.50	0.75	1.00	1.55	2.00	2.5	3.0	3.5	4.0
Thermal R-Value	3.3	5.0	6.5	10.0	13.0	16.0	19.0	22.1	25.2

Physical Properties of ISO RED Polyiso Sheathings								COMPLIES WITH ASTM C1289	
ASTM Method	D1621	C209	E96	D2126	D2126			E84	
	Minimum Compressive Strength, psi	Water Absorption	Water Vapor Transmission, perms	Dimensional Stability % change	Nominal Density, pcf	Service Temperature Range, F	Flame Spread	Smoke Developed	
ISO RED MAX Type 1, Class 2	25	<0.06	<0.3	<0.2	2.0	-50 to +250	<25	<450	

Poly ISO Grades & Available Facers			
Grade	Front Facer	Back Facer	Seam Finish Options
ISO RED MAX WF	1.25 mil white embossed	0.9 mil foil	Venture (1558 HT) White Victory Bear PVC Trim Pieces
ISO RED MAX LD	1.25 mil white embossed	1.25 mil foil embossed	Venture (1558 HT) White Victory Bear PVC Trim Pieces
ISO RED MAX HD	3.4 mil white embossed	1.25 mil foil embossed	Venture (1558 HT) White Victory Bear PVC Trim Pieces

OX ISO RED MAX Installation

1. Store ISO RED MAX inside or protected from precipitation and standing water.
2. Measure and cut boards with knife or saw. Be careful to not mar white surface in cutting step.
No allowance for expansion or contraction of the ISO RED MAX is necessary.
3. If applicable, install starting PVC trim pieces (below) to walls per manufacturer's instructions.
4. For mechanical anchorage, use suitable anchor for substrate with 1" washer.
Recommended minimum attachment: 12" perimeter, 18" field.
5. For construction adhesives, place 3/8" horizontal bead every 5' and at perimeter of board.
For PVC trim pieces, place 3/8" bead of adhesive to inside of PVC trim top flange.
Also place a bead of adhesive at top edge of board. (Sikaflex-201, DC 790, Vulkem 116, Liquid Nails Heavy Duty or equivalent). Mechanical anchors may be used to supplement adhesives.
6. Finish edges and seams with white tape (below) or PVC trim pieces (below).
7. **CLEANING:** Can be pressure washed up to 1000 psi from a distance of at least 3 feet with a 15-degree or greater spray tip.

Joints/Edges

Tape

3M™ Venture 1558HT White Aluminum Tape
www.3M.com



PVC Trim Pieces

Victory Bear Flex-Tite or Quick-Clip PVC Trim Pieces
www.victorybear.com

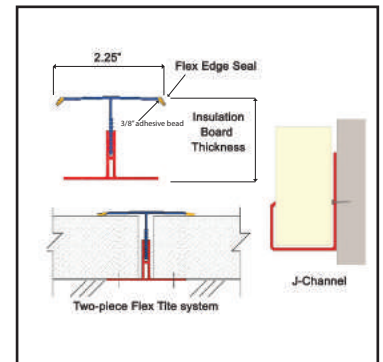
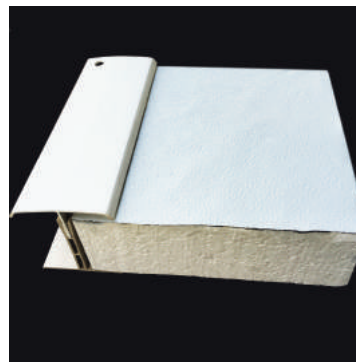

Notice: Customer is responsible for complying with all applicable laws, regulations, and building codes (collectively, "Laws") of the location where any products (individually, "Product" and collectively, "Products") manufactured by Ox Engineered Products, LLC ("Ox") are actually used, specifically including, but not limited to, Laws regarding use and disposal of the Products by Customer. Ox expressly disclaims all liability for the Products other than as expressly provided in the applicable warranty for the Product (the "Product Warranty") which is available from Ox at the address below. OX EXPRESSLY DISCLAIMS ANY OTHER WARRANTY EXPRESS OR IMPLIED INCLUDING SPECIFICALLY, BUT NOT LIMITED TO, ANY WARRANTY OF MERCHANTABILITY OR FITNESS FOR A PARTICULAR PURPOSE. None of the information contained in this brochure shall act as a waiver of any patent, trademark, copyright or other intellectual property right of Ox, nor shall any such information expand any rights or remedies set forth in the applicable Product Warranty. Ox shall not be liable for compliance of the Products with any test results obtained by third parties that may be included in this brochure. Actual results may vary. Not all Products are approved for use in all jurisdictions. The Products are not load bearing. Do not attempt to walk on them. Some Ox Products are flammable. Ox disclaims liability for damages caused by incineration of the Products. By purchasing the Products, Customer irrevocably consents that any dispute arising between Ox and Customer will be determined under Michigan law without consideration of any conflicts of law analysis and that any such dispute shall be brought only in the state or federal courts serving the locality in which Ox's headquarters are then located. By purchasing the Products, Customer expressly consents to the exercise by such courts of personal and subject matter jurisdiction and venue for such purposes. Ox Engineered Products offices are located at 22260 Haggerty Road, Suite 365, Northville, Michigan 48167. Phone (800) 345-8881.