



Thermo-ply®

STRUCTURAL SHEATHING

Thermo-ply® Structural Sheathing for Strong Structures:

*Strengthen your building envelope and bottom line with
Thermo-ply® Structural Sheathing.*

*A stable-priced, high-performance alternative to wood structural panels,
Thermo-ply® meets or exceeds building codes, provides an efficient WRB and
best in class Air Barrier.*



BUILD THE BETTER WALL

Walls built with **Thermo ply**® are High Performance Walls

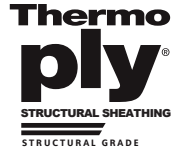

STRONG WALLS

Composed of pressure laminated plies consisting of high-strength cellulosic fibers. Fibers are specially-treated to be water resistant and are bonded with a proprietary water-resistant adhesive. A protective polymer layer is applied on both sides of the panel, and foil facings may be applied on one or both faces.

STRONG WATER RESISTANCE and AIR BARRIER

- Factory-extrusion coating for built-in Water Resistive Barrier with 3/4" (min.) overlapped joints OR taped joints.
- Air tight seal to studs reduces air leakage and provides best-in-class air barrier
- AMG (Advanced Moisture Guard) option provides adhesive with the 3/4" overlap. Provides self-adhesive overlap panel joints for even tighter water and air barrier performance.

STRONG ENVIRONMENT

- No harmful chemicals, VOC's, or toxic bonding agents added.
- No added asphalts, formaldehyde, phenols or CFCs
- Made from 94% recycled fibers and is 99% recyclable

STRONG COMPETITIVE EDGE and BOTTOM LINE

- Stable pricing
- Exterior Wall Sheathing and Bracing
- Interior Shearwall Bracing
- Interior air barrier and draft stop
- Temporary surface protector for floors and countertops.
- Light-weight, durable and easy installation
- Custom sizes and private label
- Made in USA

THERMO-PLY GRADES

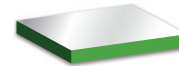

GREEN/GREEN AMG

Light Structural Grade .078" thickness, 290 lbs/MSF, 400 sheets per skid



RED/RED AMG

Standard Structural Grade, 0.113" thickness, 414 lbs/MSF, 300 sheets per skid



BLUE/BLUE AMG

High Structural Grade, 0.135" thickness, 504 lbs/MSF, 250 sheets per skid

THERMO-PLY OPTIONS: ALL AVAILABLE ON ALL GRADES

- 48" or 48- 3/4" widths at no MSF up charge
- 49" width for AMG
- 8', 9' or 10' lengths at no MSF up charge
- Custom lengths up to 14' available

Thermo-ply	OSB
94 % post consumer recycled content, no added formaldehyde or toxic agents	Made from wood chips, may contain formaldehyde
Stable Pricing	Commodity - rapid price fluctuations
Extrusion Coated WRB both sides	Requires additional WRB layer
High moisture tolerance	Low moisture tolerance - significant swelling when wet. Source for mold
Tight seal controls air infiltration for lower ACH	Average air infiltration performance
Custom sizes and private labeling available	Typically no custom sizes or print available
~ 13 lbs for 4'x8' sheet (RED)	45 lbs for 7/16"x 4'x8' sheet

*Formaldehyde is classified as a probable human carcinogen by the U.S. Environmental Protection Agency.

Thermo-ply® is a registered trademark of OX Engineered Products, LLC and all other trademarks, registered trademarks, copyrights and logos are the property of their respected owners.

APPLICATIONS:

- Wall sheathing for buildings constructed in accordance with IRC and IBC for light-frame construction
- Structural wall sheathing to provide lateral load resistance (wind and seismic) for braced wall panels used in light-frame construction
- Structural wall sheathing to provide resistance to transverse loads for wall assemblies
- Structural wall sheathing to provide resistance to uplift loads for wall assemblies
- Approved WRB
- Approved air-barrier material
- Where other means of wall bracing are provided or not required, any grade of Thermo-ply may be used in non-structural applications as outlined in DRJ Evaluation Reports
- Gable Ends on Trusses
- Air barrier behind shower units and other internal sheathing applications that require a thin air-barrier or draft stop.
- Temporary floor or surface coverings protection
- Templates and Layout

THERMO-PLY® INSTALLATION INSTRUCTIONS/ Instrucciones de Instalacion

1. Orientation & Fastener Pattern/ Orientacion

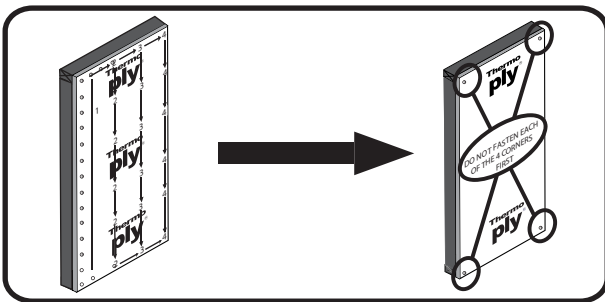

Install vertically or horizontally (edges blocked and fastened). Fastener Pattern for Structural: 3"/3" o.c. Start at #1 and move across panel. DO NOT fasten 4 corners first. DO NOT use as a nail base.

Instalar vertical o horizontal (cantos bloqueado y abrochado) Fija a 3"/3" o.c. Trabajando de un lado a otro del panel, empiece a asegurar de arriba hacia abajo. (Referirse a las instrucciones de instalacion al frente del panel) CUIDADO DE NO ASEGURAR PRIMERO LAS CUATRO ESQUINAS. Cuidado de no puede ser usado como un base para clavar.

3. Joints/Water Resistive Barrier Options/ Junturas

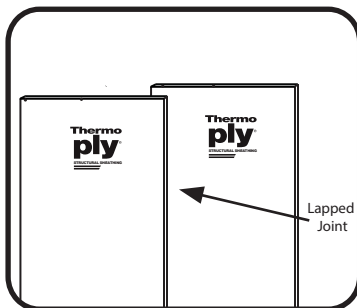

Overlapped 3/4" (min.)

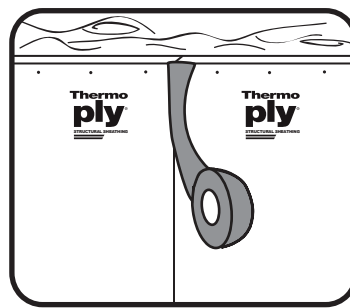

Butted and Taped

To achieve approved WRB, joints can be:

Overlapped OR butted and taped with approved tape (3M8087, or Venture 1585CW-W or Equivalent). Lapped seams should be overlapped by 3/4" (min.) and fastened with single row fasteners.

Para WRB, puede ser doblado o unido a los lados apropiado (3M8087, o Venture 1585CW-W, o Equivalente). Usando cinta de construccion aprobado. Junturas superpuesto para 3/4" (min.) y elementos de fijacion de una hilera

2. Fastening/Fijacion

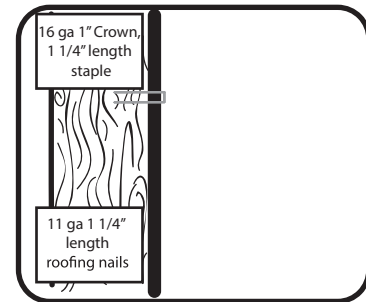

Use 16 gauge 1" crown, 1 1/4" length staple OR 11 ga. 1 1/4" length roofing nail. Staple crown should be flush. DO NOT countersink. Staples must run parallel with wood grain of framing studs at sheathing seams.

Necesita estar instalando usando 16 calibre, minimo 1" grapa corona, 1 1/4" largo grapas galvanizado. Los cerrojos necesitan clavar a ras de la superficie, sin cortar el superficie (cantos bloqueado y abrochado) Es importante cuando se usan las grapas de asegurarlas en la direccion paralela en el tachon.

INSTALLATION

General for Structural and WRB Applications

All Thermo-ply Grades shall be installed in accordance with the manufacturer's published installation instructions in the Evaluation Report. Where Thermo-ply extends beyond the bottom of a wall and overlaps the band joist below, fasten the bottom edge of the Thermo-ply to the wall bottom plate where it meets the band joist. Due to shrinkage of the band joist, do not fasten the sheathing to the band joist.

Window Treatment: If windows and doors are made to accommodate traditional 1/2" sheathing materials, order window with adjustable nailing fins from the supplier. Door brick moldings may be planed or routed 5/16" in order to accommodate the different sheathing thickness, whether at the jobsite or from the millwork supplier. Thermo-ply must be installed with appropriate flashing and counter flashing in conformance with manufacturer's install instructions, accepted building standards and in compliance with local building codes.



Physical Properties Thermo-ply Structural Sheathing					
Physical Property	Standard	Test Result			Unit of Measure
R-value	ASTM C518	Green: .13	Red: .18	Blue: .20	F. Ft ² . h/Btu
Drainage efficiency	ASTM E2273	97.8			%
Sound Transmission*	ASTM E90	STC 39			dB
Water Absorption	ASTM D1037	< 15			%
Permeability	ASTM E96	<0.6			perms
Air Barrier	ASTM E2178	< 0.02			L/s/M ² @ 75 Pa

*As measured in a typical 2x4 wall assembly with R-13 batt and 1/2" GWB.

PRODUCT NAME AND DESCRIPTION:
THERMO-PLY STRUCTURAL SHEATHING

BASIC USE:
Thermo-ply is a code-approved exterior structural sheathing, water resistive barrier and air barrier. Reference DrJ Technical Evaluation Reports 1004-01, 1004-02, 1004-03.

COMPOSITION AND MATERIALS:
Composed of pressure laminated plies consisting of high-strength cellulosic fibers. These fibers are specially-treated to be water resistant and are bonded with a proprietary water-resistant adhesive. A protective polymer layer is applied on both sides of the panel, and foil facings may be applied on one or both faces.

TECHNICAL DATA:
Construction Specifications Institute
Identification Codes: Sheathings: 06115
Structural Panels: 06120
Building Insulation: 07210
Draft Stop: 07270

STRUCTURAL:
Transverse and Lateral wall bracing in compliance with the IRC and the IBC Type V Construction.

AIR & WATER RESISTIVE BARRIER:
When installed in accordance with manufacturer's install instructions, Thermo-ply is approved as WRB and air barrier. All joints must be installed with one of two techniques:
1. Joints overlap at least 3/4" OR
2. Joints are taped with approved tape.

COMPONENT OF 1-HOUR FIRE ASSEMBLY:
See DrJ Evaluation Report 1510-04 for use of Thermo-ply in a 1-hour fire-rated wall system in accordance with the Standard Methods of Fire Tests of Building Constructions and Materials using ASTM E-119 testing procedures.

STORAGE:
Maintain packaging protection until using the product. If stored exposed without protective packaging, cover with waterproof tarpaulin. Do not store directly on the ground unprotected or in standing water. Normal care should be taken to avoid excessive moisture exposure (soaking) to un packaged product.

AVAILABILITY:
Visit www.oxengineeredproducts.com to find an OX Sales Rep near you.

NOTICE: Applicable laws may differ and change in each jurisdiction the product is used; Customer is responsible for determining whether the Product and the Information in this document are appropriate for Customer's use and for insuring that Customer's workplace and disposal practices are in compliance. The Claim made may not have been approved for use in all jurisdictions. Ox Engineered Products, LLC, ("Ox") assumes no obligation or liability for the information provided herein. The Product represented herein may not be available for sale and/or available in all geographies where Ox conducts business. Ox reserves the right to defend any patents or other intellectual property rights and does not infer any transferability herein. Ox assumes no obligation or liability from the information provided herein. ALL WARRANTY INFORMATION IS PROVIDED IN THE TERMS AND CONDITIONS OF THE PRODUCT ITSELF; NO EXPRESS WARRANTIES ARE PROVIDED HEREIN. All disputes, claim, or actions regarding the Product shall be determined under the applicable laws of the Commonwealth of Pennsylvania and have the proper and exclusive venue in the York County Court of Common Pleas, York, Pennsylvania, or the Federal Circuit Court for the Middle District of Pennsylvania.